

SPECIFICATIONS

Type	Air-Cooled 4Stroke-OHV Gasoline Engine with Start Cylinder	
Number of Cylinder	(mm)	1-51.6 X 38
-Bore X stroke	(cm³)	79.6
Displacement	kw/rpm	1.3/3600
Continuous Rated Output	(PS/rpm)	(1.8/3600)
Maximum Output	kw (PS)	1.8 (2.4)
Maximum Torque	N.m/rpm (kgf-m/rpm)	4.31/3000 (0.44/3000)
PTO Shaft Rotation	Counting-Clockwise	
Fuel	Unleaded Automobile Gasoline	
Fuel Tank Capacity	(L)	1.5
Lubricating Oil	Engine Oil SE Class or Higher	
Lubricating Oil Capacity	(L)	0.4
Carburetor	Flat, Butterfly valve - Sideways suction Type	
Ignition system	Breaker less Ignition Type. Flywheel Magneto	
Spark Plug	NGK-BPR6HS equivalent(E6BRTC)	
Starting System	Recoil Starter	
Governor System	All Speed Mechanical Governor	
Lubricating System	Compulsive Splash Type	
Air Cleaner	Polyurethane Type	

(Notes1) *markshows the valueof a standard equipment state.
 (Notes2) Rotation speed is the one at the output shaft.

NOTE
 DIMENSIONS SHOWNWITHOUT ALLOWANCE
 ARE NOMINAL AND ARE SUBJECT TO PRODUCTION TOLERANCE.

DIAGRAM

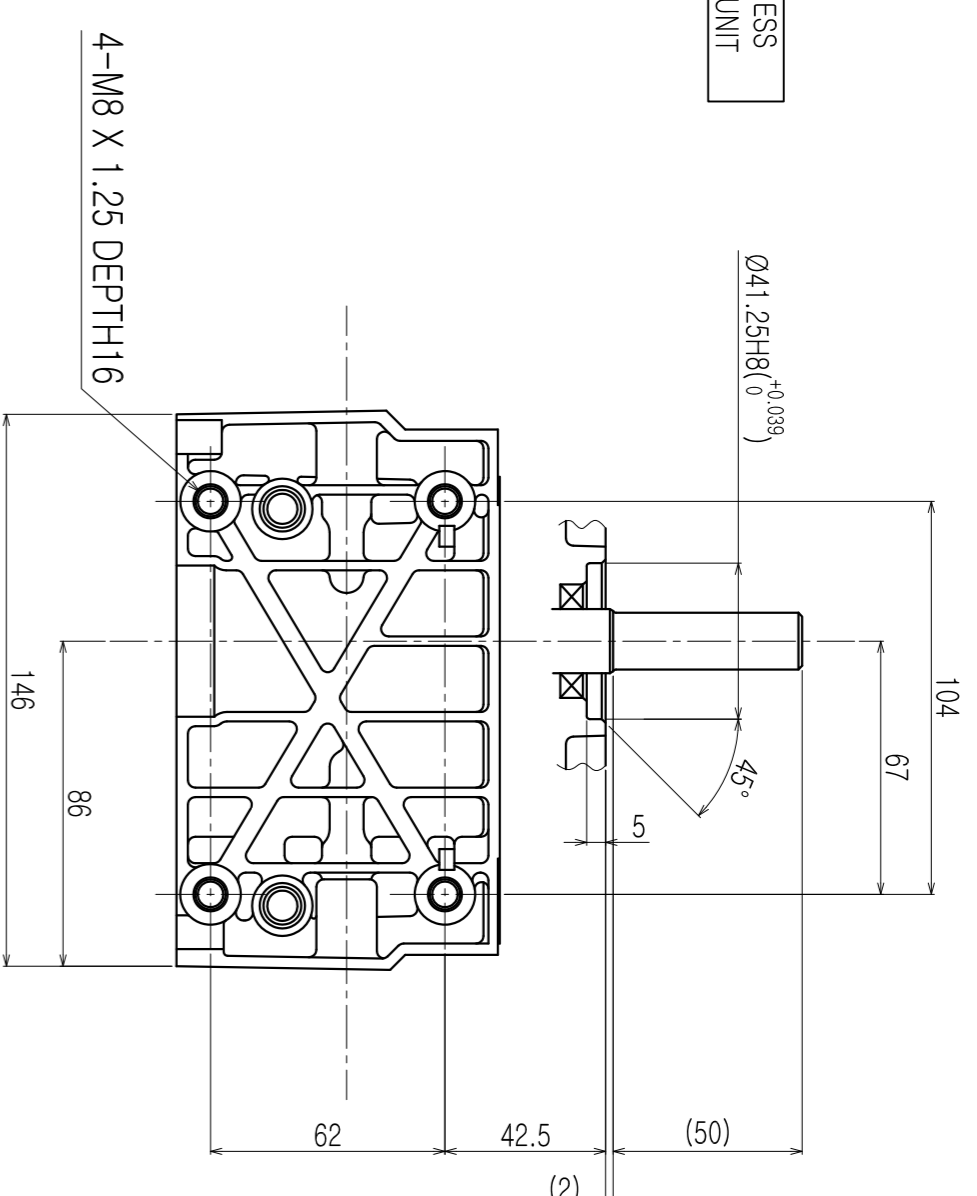
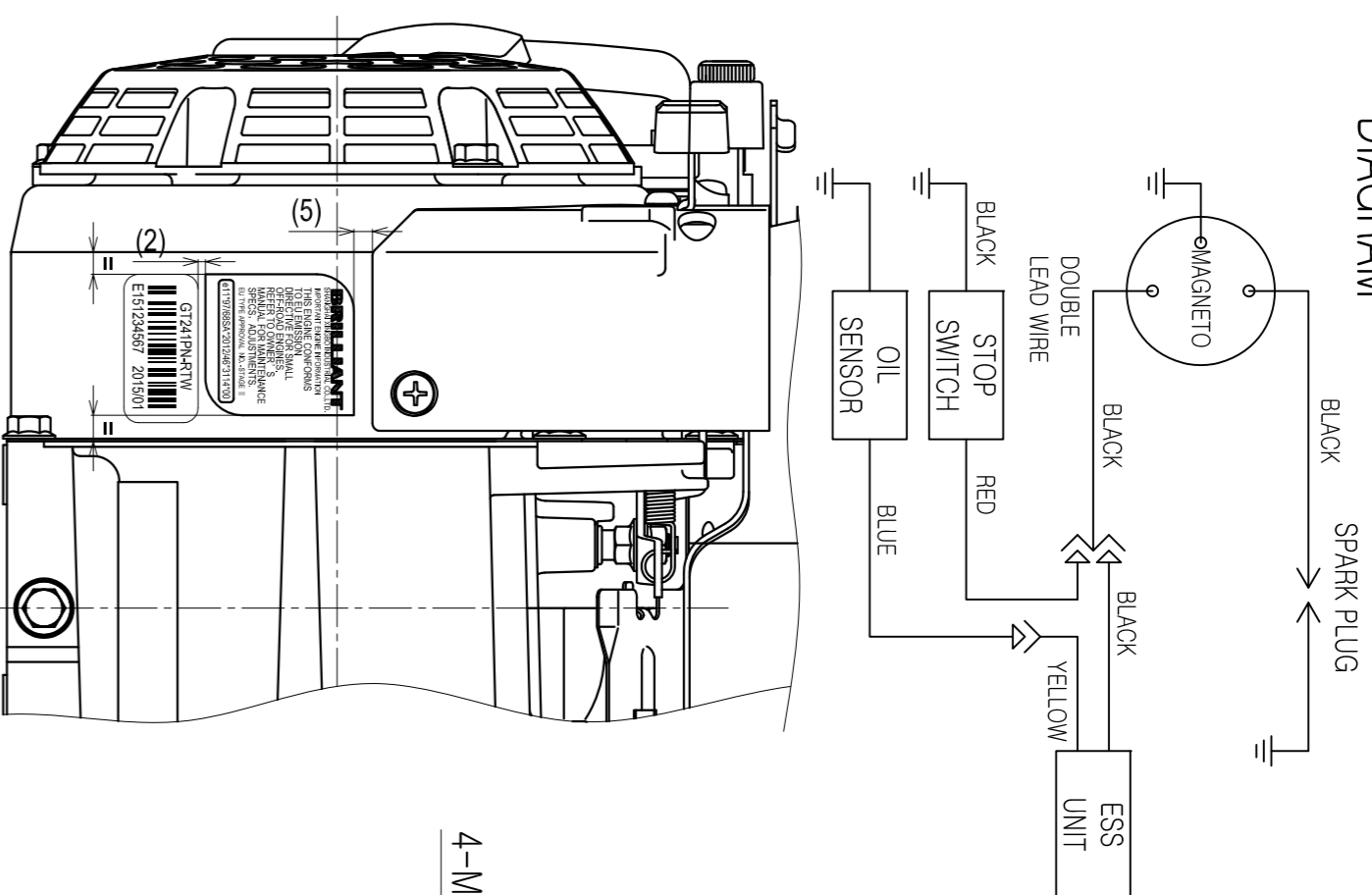

VIEW P

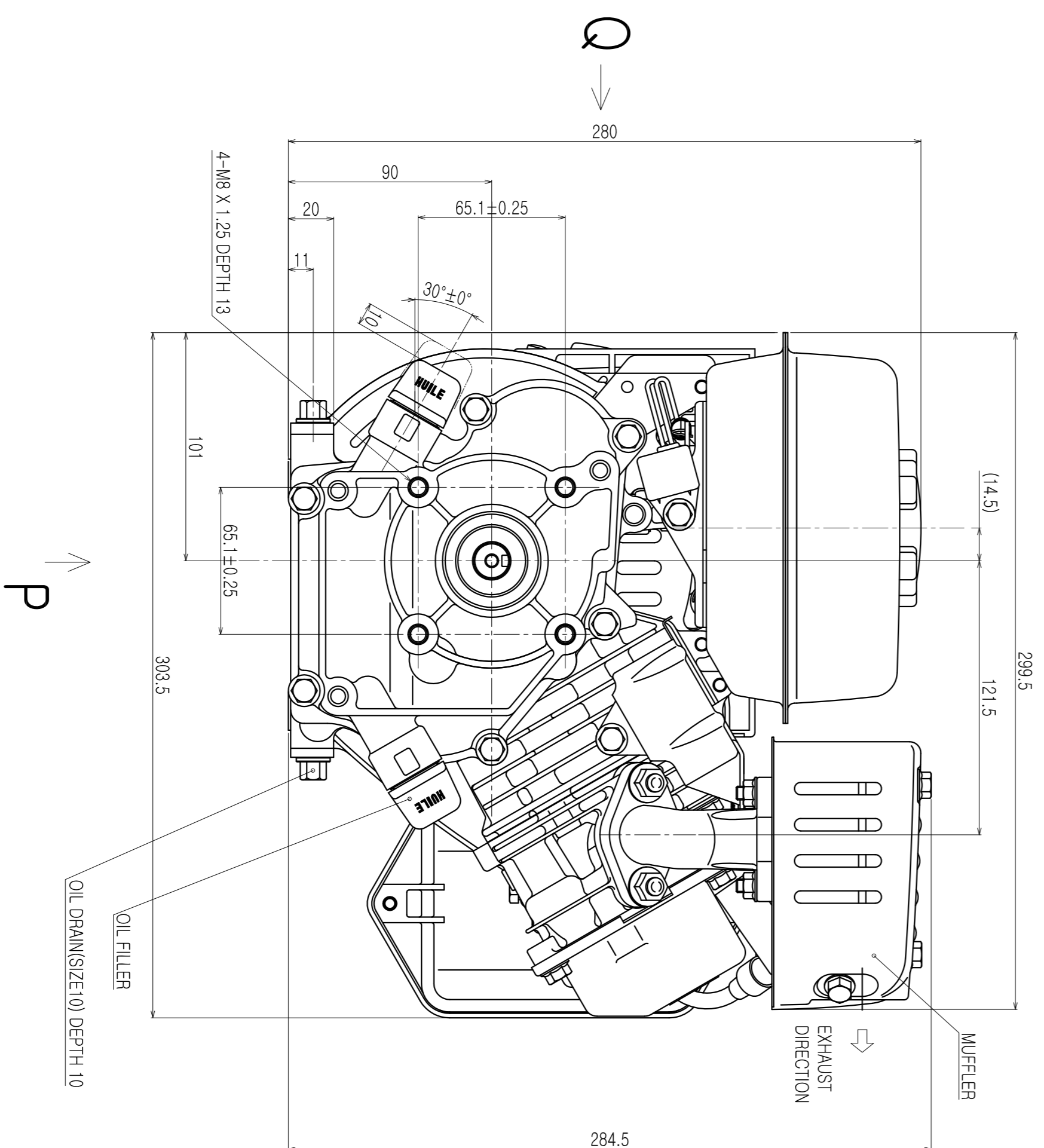

VIEW Q

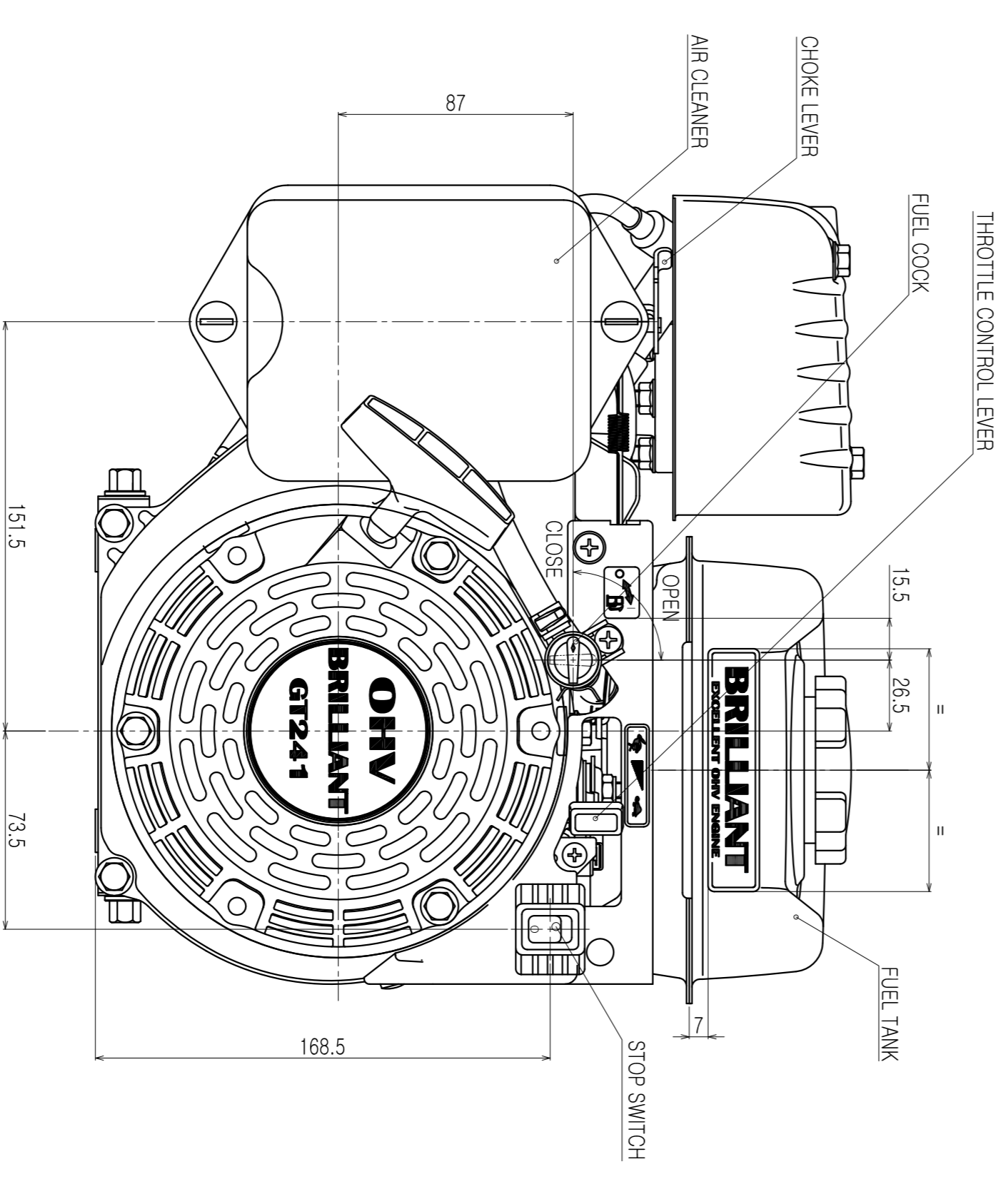
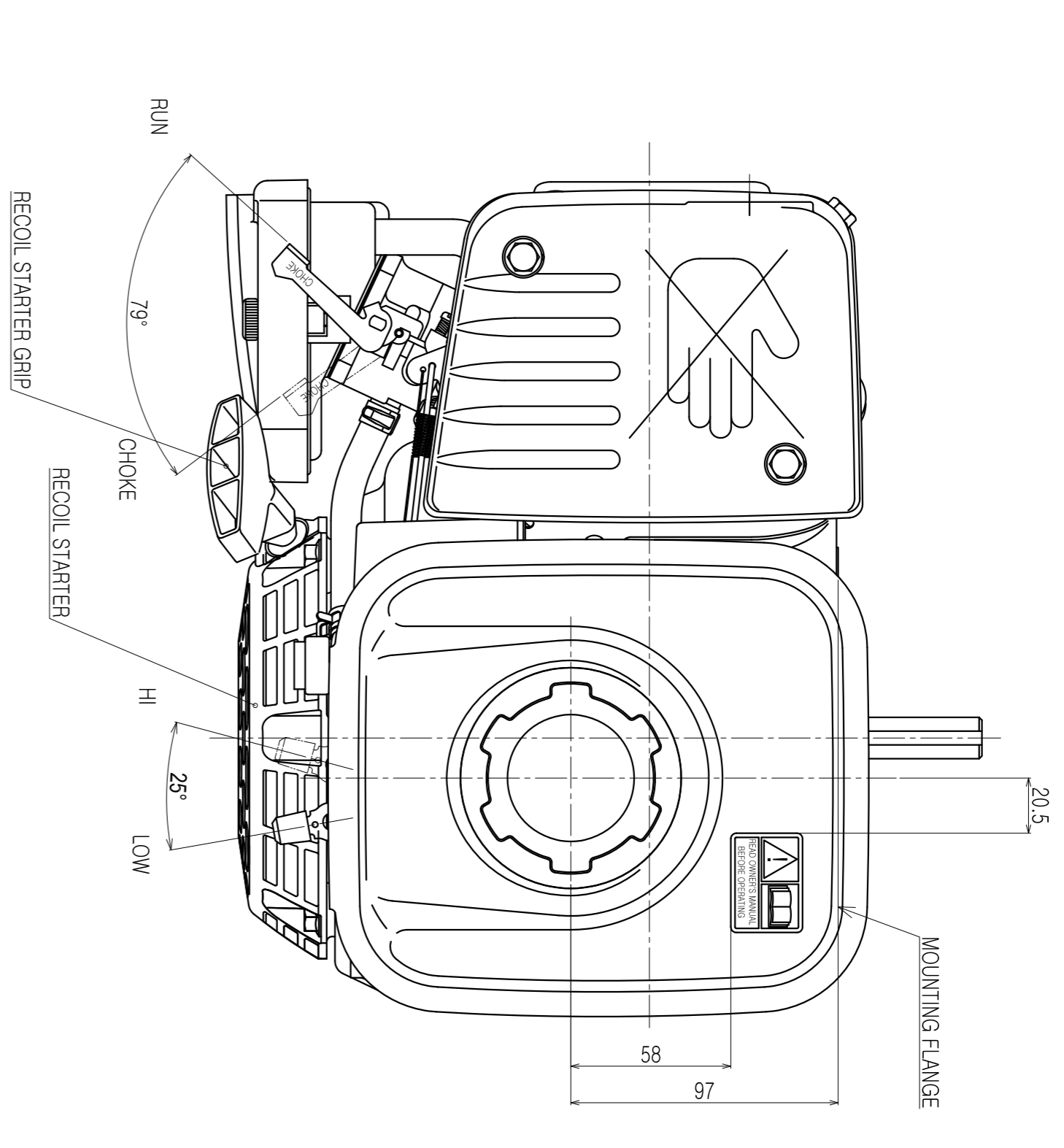
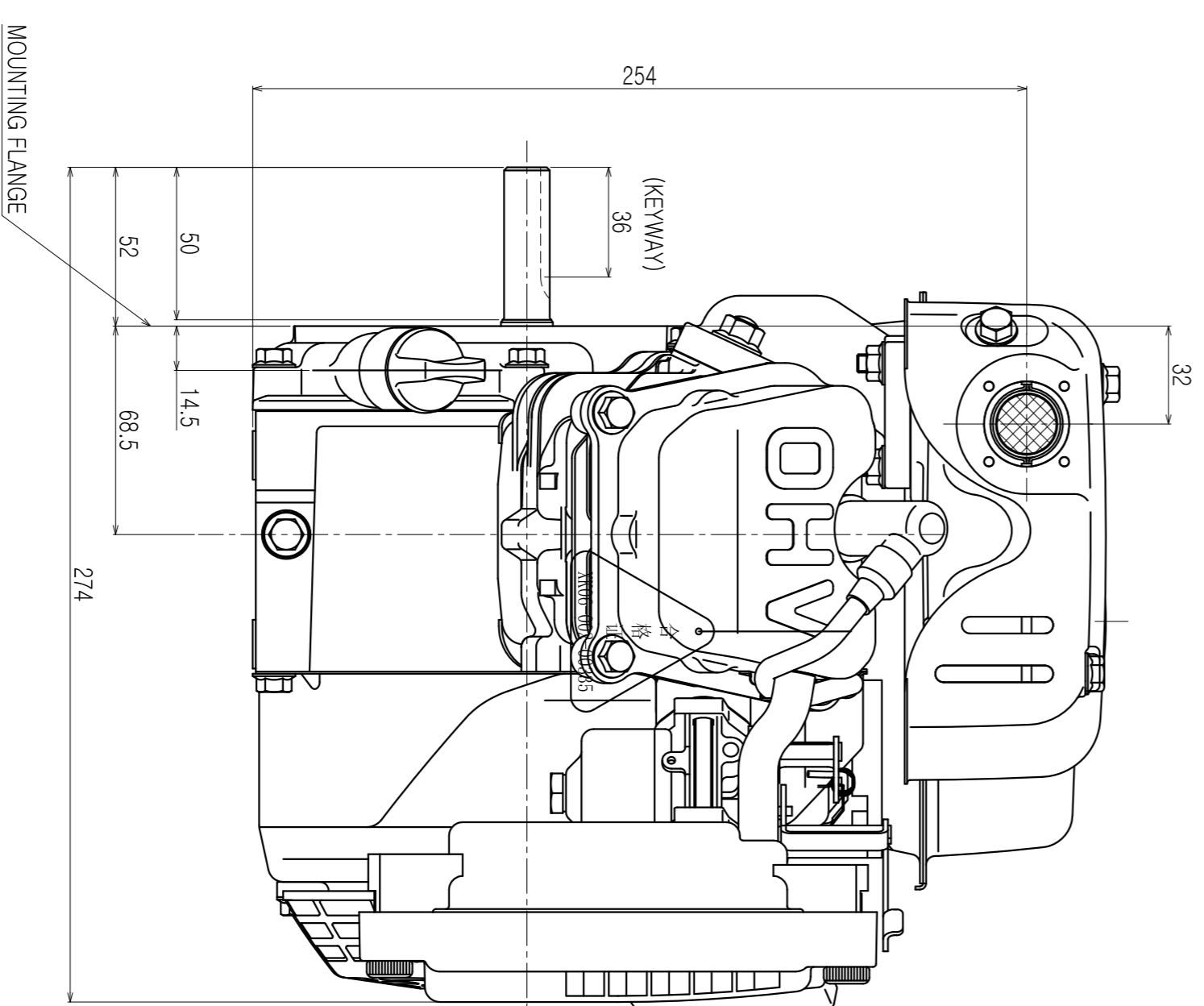
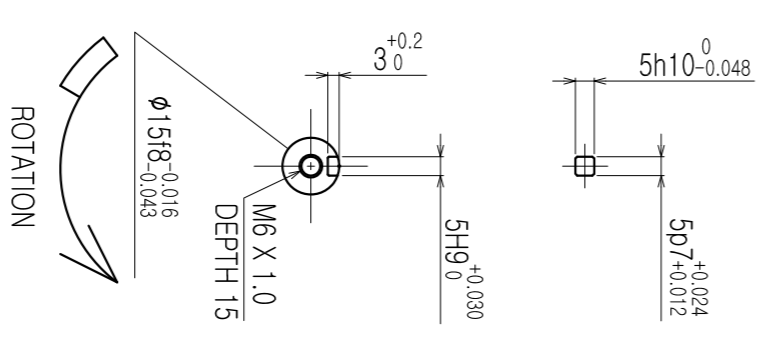

名称	GT241	比例	1:2	材料	BM
形式	GT241	认可		绘图	
名称	ENGINE, INSTALLATION, GT241PN-R.TWA	比例	1:2	材料	BM
形式	GT241	认可		绘图	

博取集团 上海兴博实业有限公司