

# SPECIFICATIONS

Type	Air-Cooled 4Stroke-OHV Gasoline Engine with Start Cylinder	
Number of Cylinder	(mm)	1-68 X 50
-Bore X stroke	(cm³)	181.6
Displacement	kw/rpm	3.3/3600
Continuous Rated Output	(PS/rpm)	(4.5/3600)
Maximum Output	kw (PS)	4.4 (6.0)
Maximum Torque	N.m/rpm (kgf-m/rpm)	11.6/2800 (1.18/2800)
PTO Shaft Rotation	facing PTO	Counter-Clockwise
Fuel	Unleaded Automobile Gasoline	
Fuel Tank Capacity	(L)	3.8
Lubricating Oil	Engine Oil SE Class or Higher	
Lubricating Oil Capacity	(L)	0.6
Carburetor	Float , Butterfly valve · Sideways suction Type	
Ignition system	Breaker less Ignition Type · Flywheel Magneto	
Spark Plug	NGK-BPR6HS equivalent(E6RTC)	
Starting System	Recoil Starter	
Governor System	All Speed Mechanical Governor	
Lubricating System	Compulsive Splash Type	
Air Cleaner	Polyurethane Type	

NOTE  
DIMENSIONS SHOWN WITHOUT ALLOWANCE  
ARE NOMINAL AND ARE SUBJECT TO PRODUCTION TOLERANCE.

## DIAGRAM

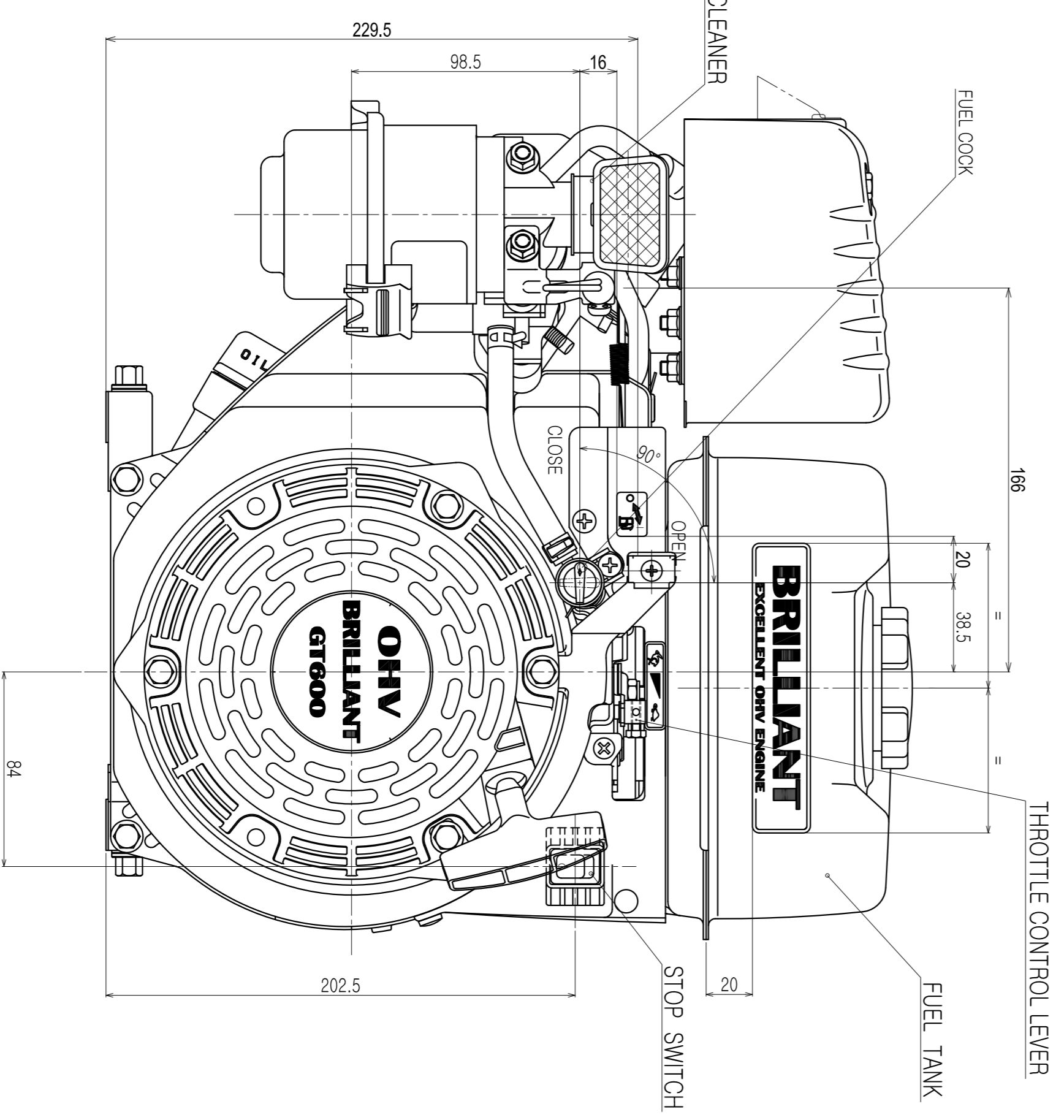
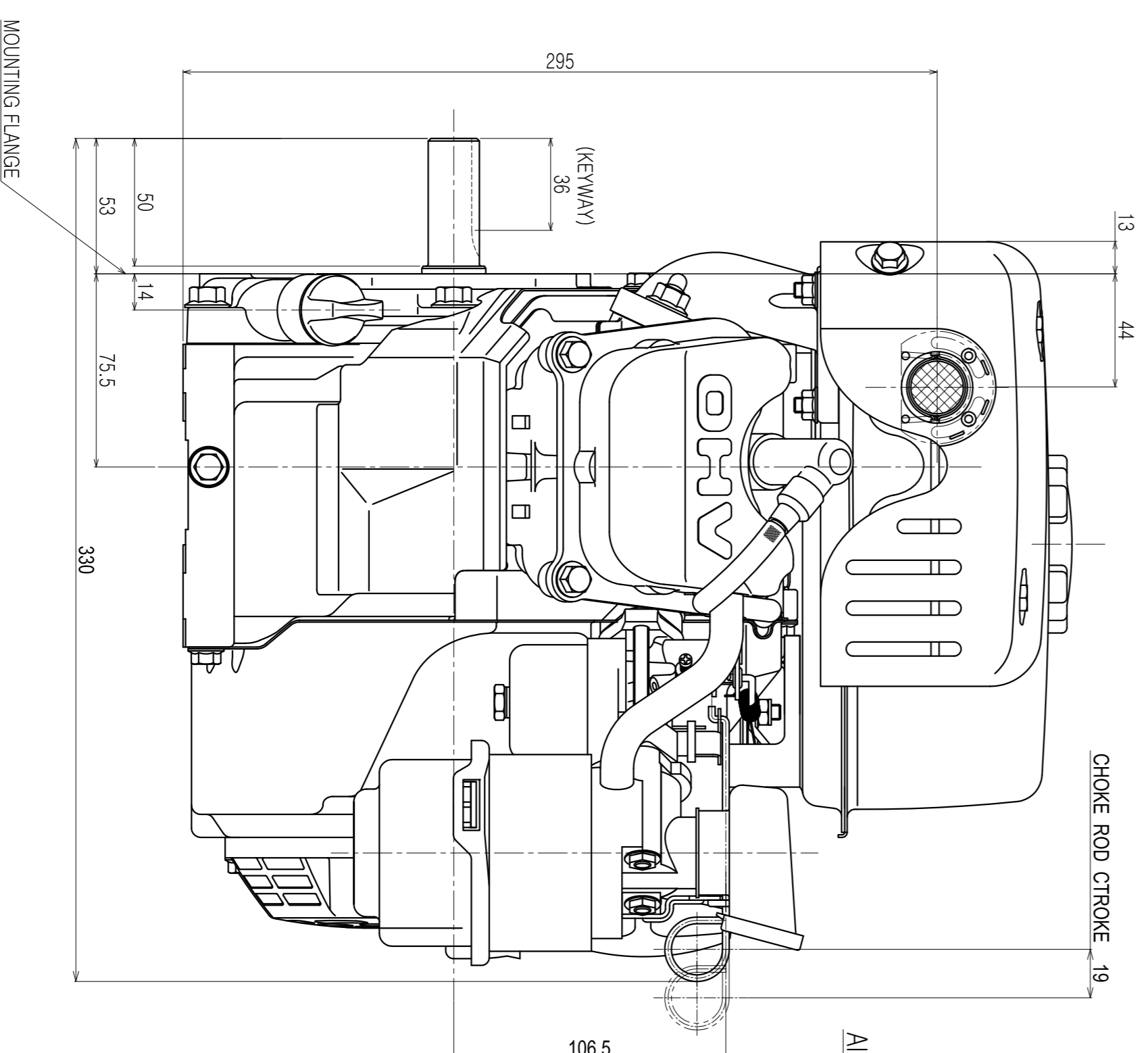
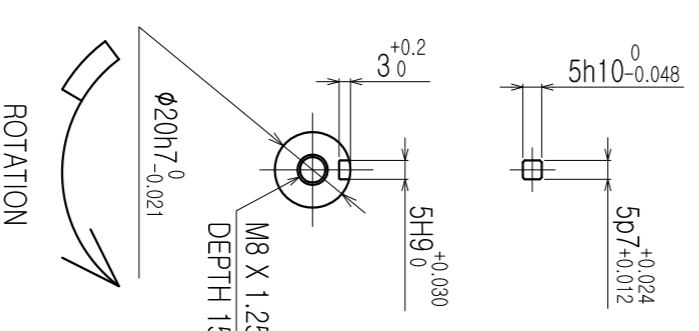
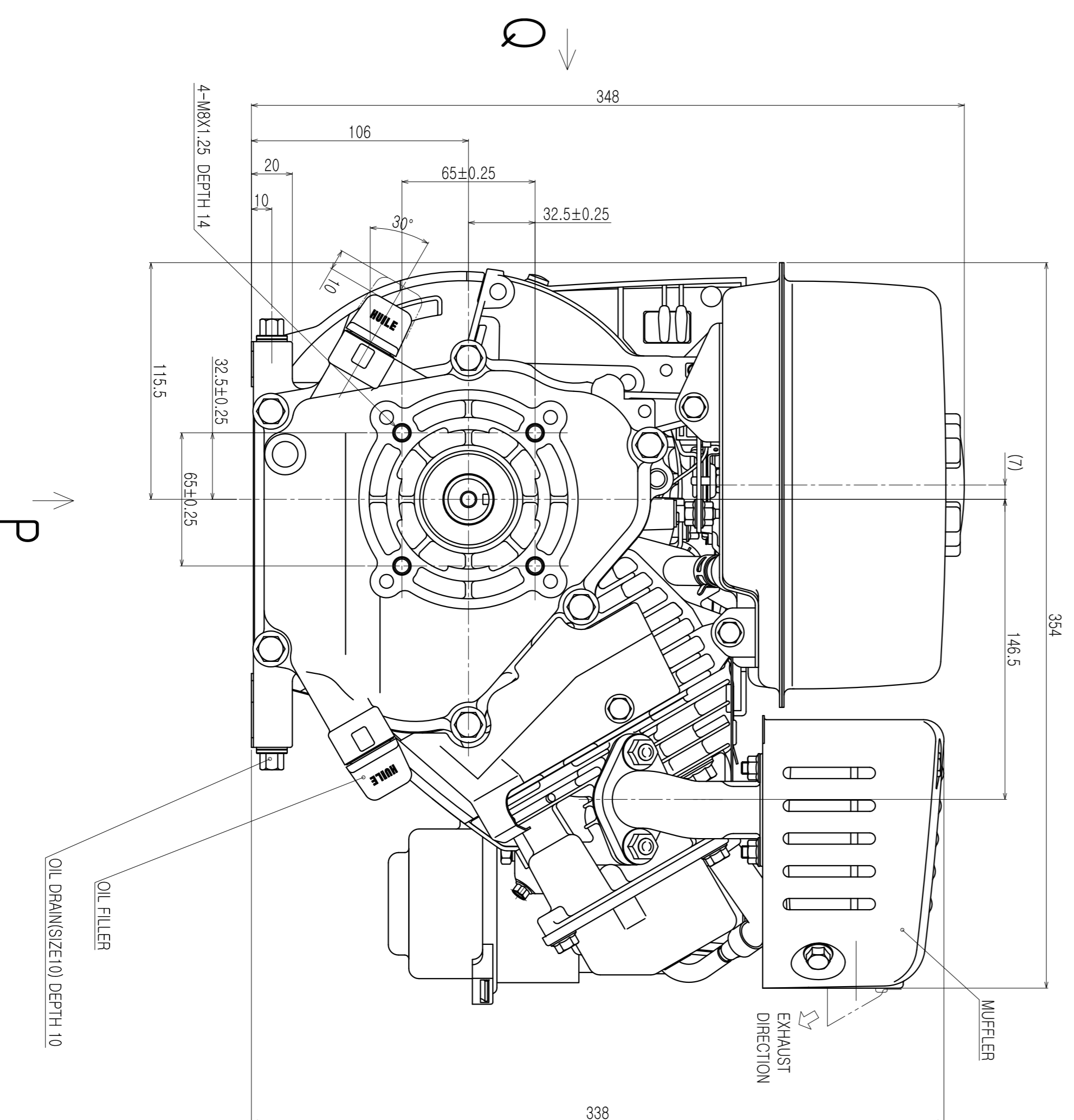
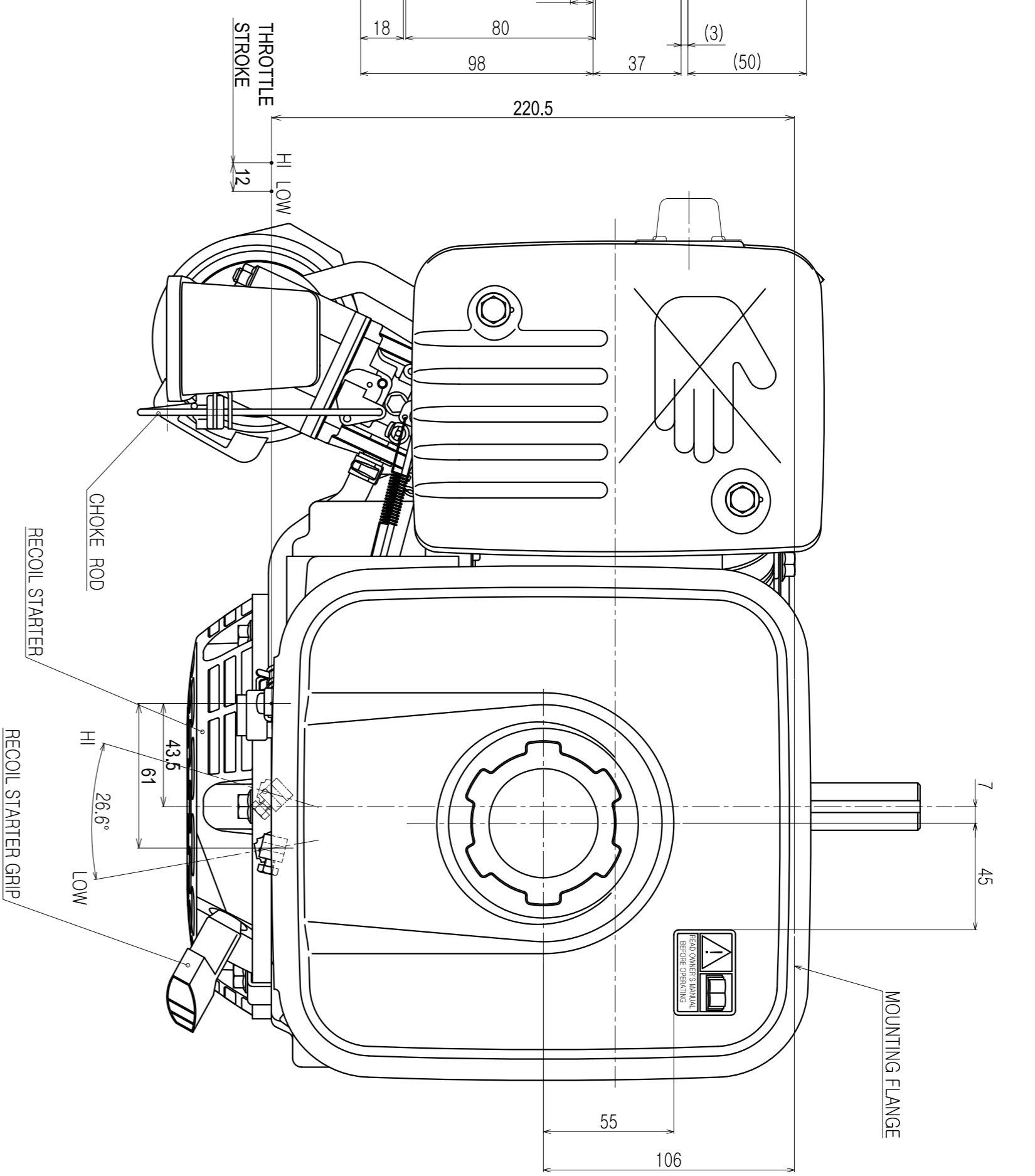
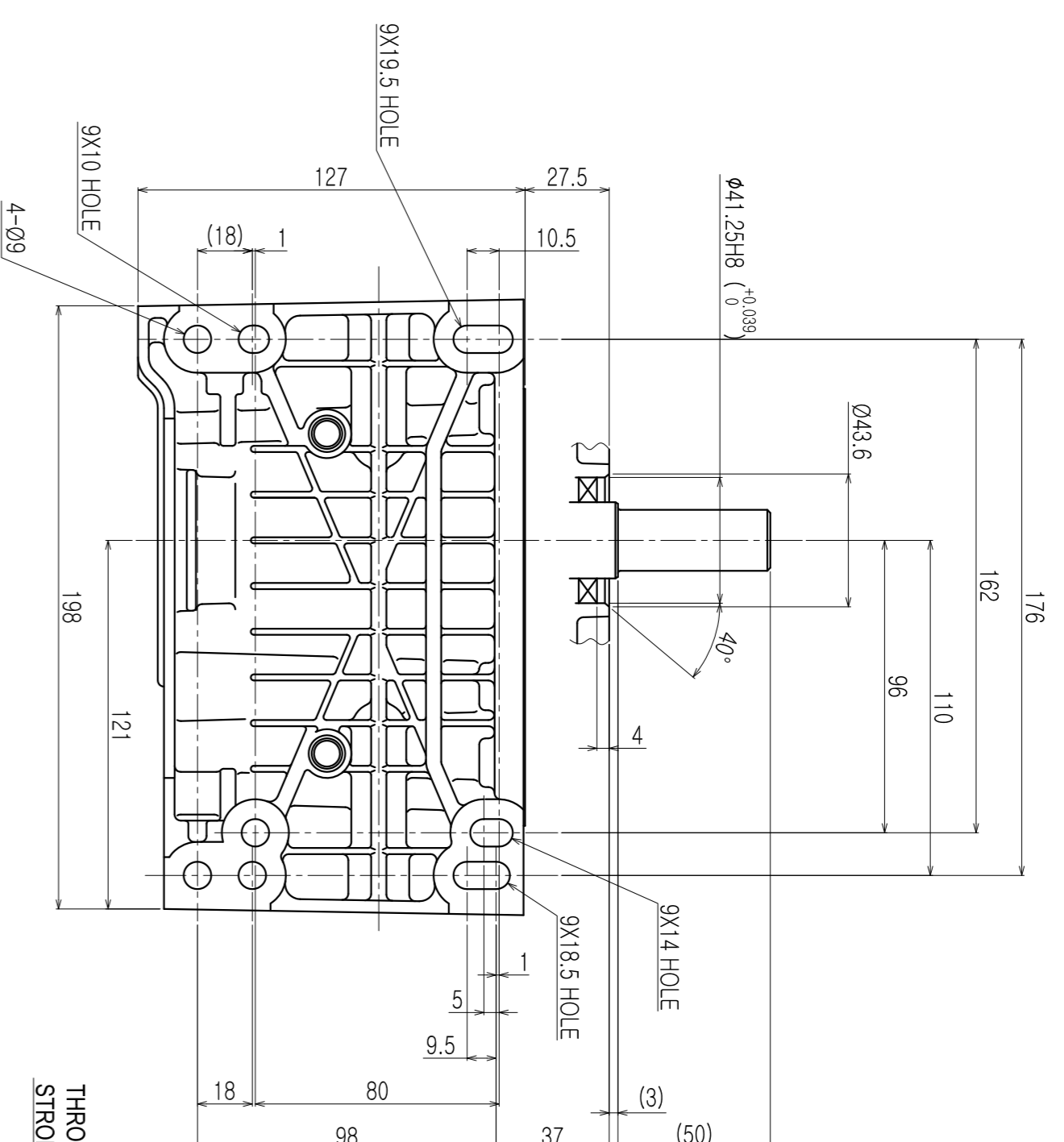
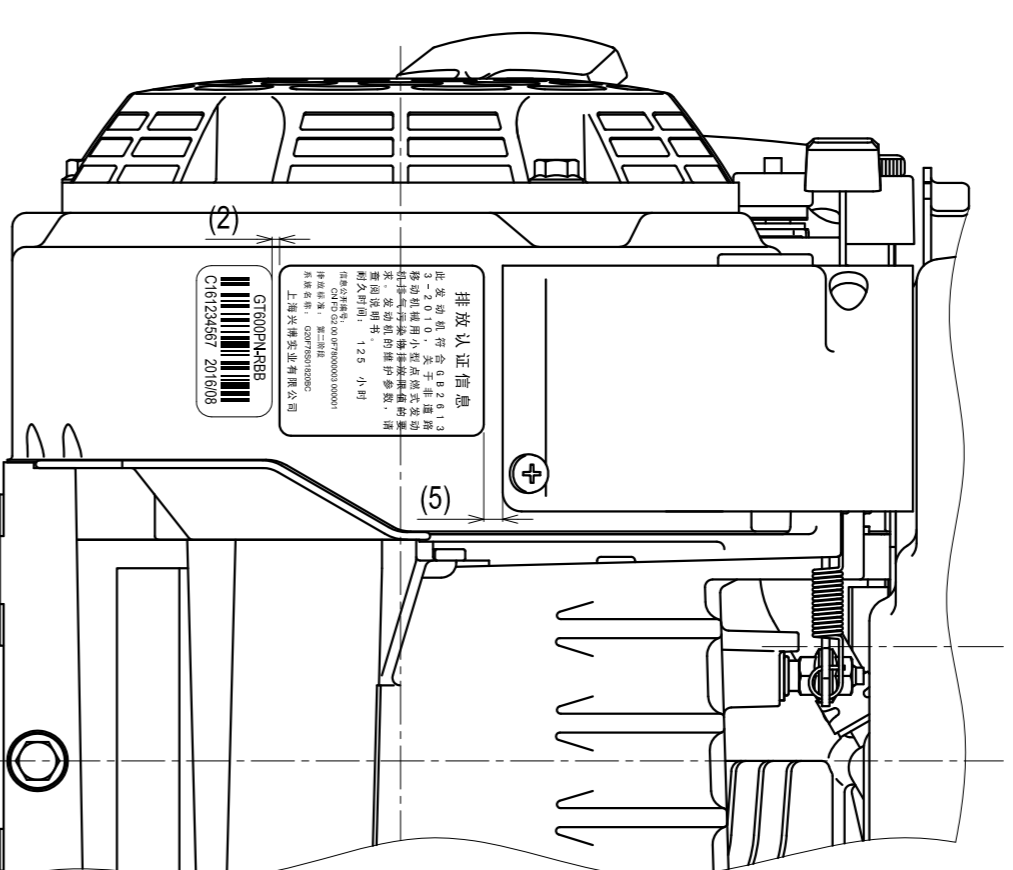
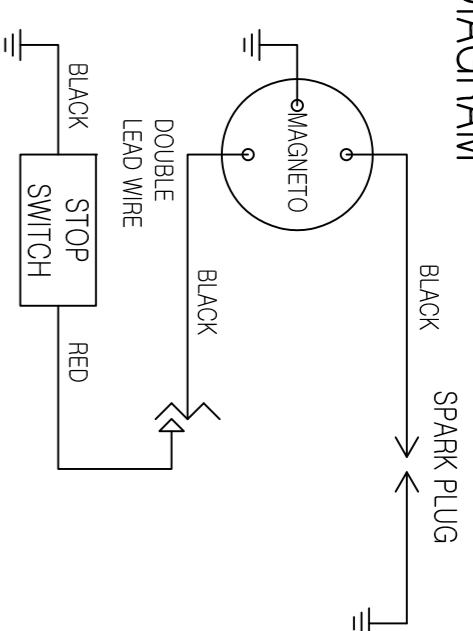

形式	GT600	认可	检验	制图
名称	引擎	比例	1:2	BM
ENGINE INSTALLATION GT600PN-RBBZ				
博敏集团 上海博敏实业有限公司				

审核	设计	制图	校对	审核
日期	日期	日期	日期	日期